

# Claremont Dormitory Floor Plan— Wing rooms and Main rooms

School/group name: \_\_\_\_\_

**MAXIMUM CAPACITY**  
 40 participants and 4 group leaders.  
**NOTE:** Although Claremont's capacity is 40 participants and 4 group leaders, there is flexibility in student sleeping arrangements.

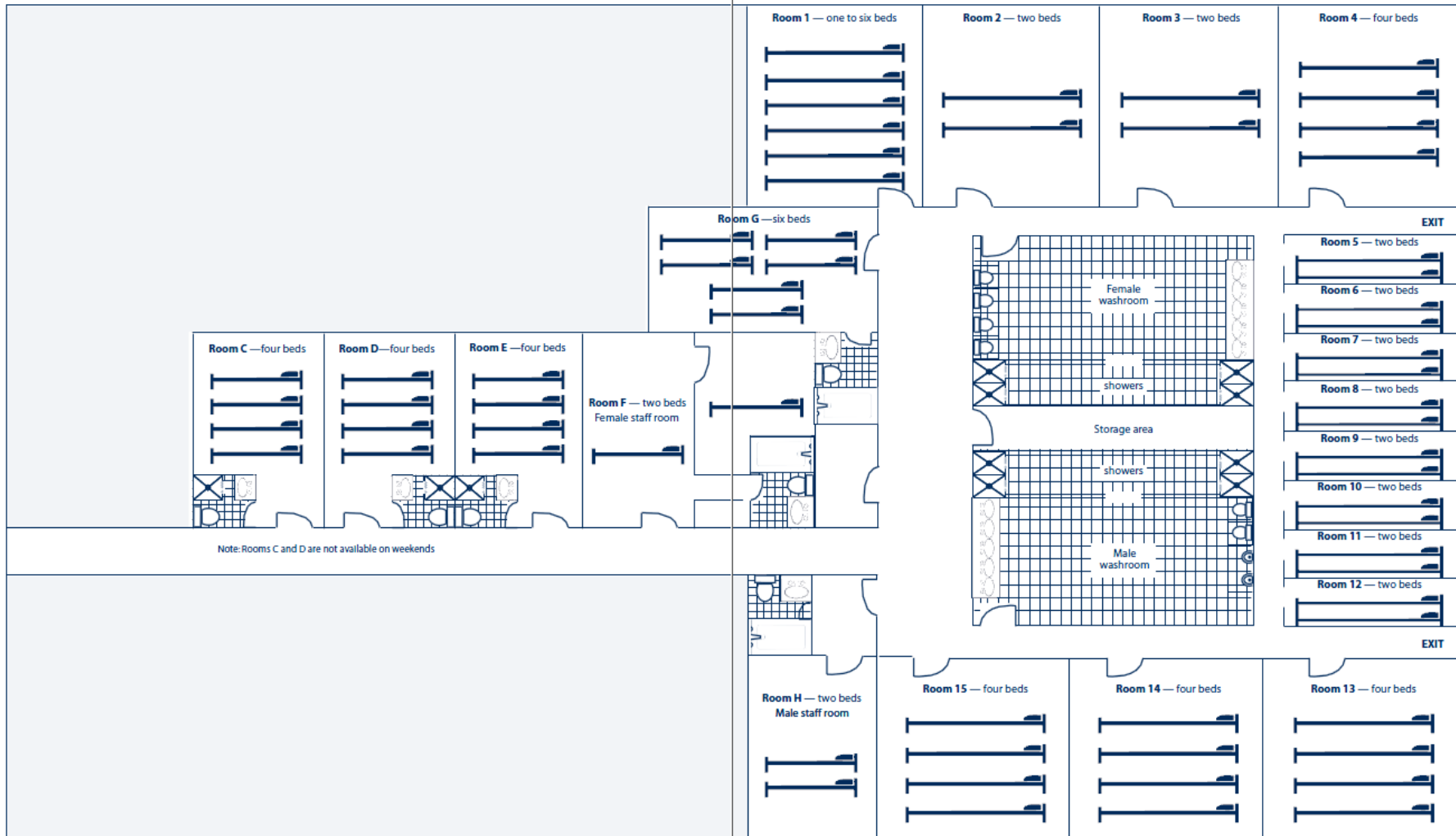

Note: Rooms C and D are not available on weekends